



Model 5049
Shown in White
with Brushed Nickel Trim

FEATURES

- 42" x 60" x 23" Oval whirlpool
- Deep bathing well
- Integral armrests and contoured seating
- Hydro-V™ back jet system: Eight jets massage the shoulder blades, upper and middle back muscles and the bottom two spinning jets massage your lower back
- Swirl-way® DryJets are adjustable in both direction and flow creating a broad, circular pattern of water and warm air for a deep venturi therapeutic massage
- Two micro jets for side lumbar massage
- Dual air controls for the ultimate jet power control
- Powerful 2 HP pump creates an invigorating whirlpool action
- "Jellybean" pillow in your choice of White, Bone or Biscuit
- Trim finish in Color-Match, Chrome, Everbrass (PVD) and Brushed Nickel
- Outstanding Protection - Mansfield® Limited Ten Year Warranty
- Available in White, Standard, Premium and Designer Colors (Consult Price Book for Specific Colors)

Enjoy the versatility of the Elba OV, a modern whirlpool that fits any bathroom. A flat deck allows under-mounting or simple drop-in installation with room for mounting faucets on the deck. A powerful jet system includes a 2 HP pump, Hydro-V™ back jet system for an invigorating back massage and four body DryJets that round out the overall massage.

Model No.	Description	Approx.Wt.
5049	42" x 60" x 23" Oval whirlpool. Specify color and options when ordering.	110 lbs. (62 kg)
5549	42" x 60" x 23" Oval bath. Specify color and options when ordering.	90 lbs. (41 kg)
LUX5049	Luxury package	
BAS5049	Basic package	



For more information or to order, call 800-325-4422.
www.whirlpoolbathtubs.com

ELBA OV

Oval Whirlpool or Bath



FEATURES & UPGRADES

Basic Package

- SimpleTouch™ 3 button control
- 2 HP single speed pump
- Pillow
- Color-Match trim



Luxury Package

- SensaSelect™ 5 button control
- 2 HP 10-speed pump
- Remote control
- Pillow
- Infusion™ 2 Chromatherapy system
- In-Line heater
- Metal trim upgrade

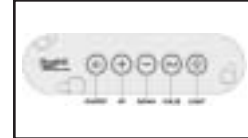

Basic Options

- Infusion™ 2 Chromatherapy system
- 1500 watt in-line water heater
- Metal trim upgrade
- Cable drain in CM, CH, EB & BN

TECHNICAL INFORMATION

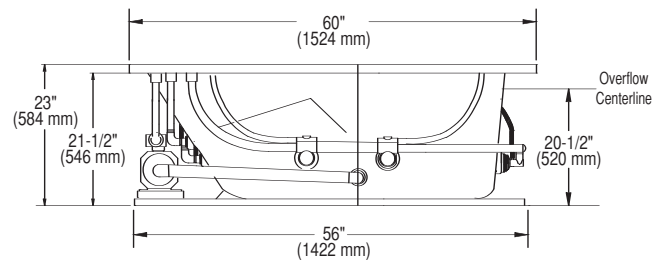
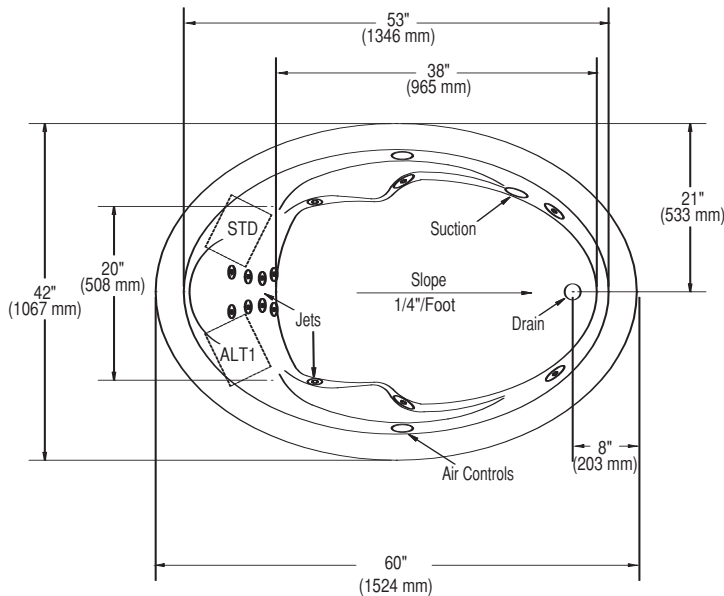

No apron available on this model

Installer Note: Due to the freeform shape of the tub shell, it is recommended that the tub be on the job before making the final cut-out for drop-in installation.

Optional pump locations shown for clarity. STD-standard pump location. ALT-1-alternate pump location. Specify one location when ordering. Nail flange not available on this unit.

Note: Rough-in measurements may vary 1/4" (6.4 mm ±).

SPECIFICATIONS

Dimensions	42" x 60" x 23" Oval whirlpool.
Material	Acrylic, fiberglass reinforced
Construction	Self-contained, pre-plumbed whirlpool bath with heat-bent rigid PVC pipe, mounted on a pre-leveled thermoformed, drip pan base
Pump Motor	2 HP, Ten speed, 120 volt, 60 HZ
Electrical Requirements	Luxury: Two separate 120 volt, 20 AMP, GFCI protected circuits Basic: One separate, 120 volt, 20 AMP, GFCI outlet

Number of Jets	Fourteen
Water Capacity	70 gal. max., 50 gal. min. (266 liters/152 liters)
Floor Loading	47 lbs./sq. ft. (229 kg/m ²)
Shipping Weight	155 lbs. (70 kg)
Warranty	Limited Ten Year

These dimensions are nominal and are subject to change without notice.
When tested for compliance to the requirement of ANSI A112.19.7M and A112.19.8M for "Whirlpool Bath Appliances" and ANSI Z124 for "Plastic Bathtub Units" the tested units are found to comply and are acceptable for listing under the Terralab Engineers, Inc. follow-up service. Listed Number 15197.
Certified for permanent electrical supply connection only.

